

### High voltage cable coupler 8 kV

Manufacturer: Patton and Cooke, Canada

Series PK/RK

Contact Structure: 3 Power - 1 Ground - 1 Pilot



The cable couplers are for quick and easy junction of high voltage cables.

|                     |            |
|---------------------|------------|
| Rated Voltage (3AC) | 8 kV~      |
| Rated Current       | 250 A      |
| Frequency           | 50 - 60 Hz |

The high voltage cable couplers are available for in cable and equipment mounted versions. The standard terminations for phase, pilot and ground conductors are designed for soldering.

Cable coupler options:

- solderless termination (Allen head screws)
- up to 3 additional Pilots and 2 additional Ground contacts
- leg mounting options
- live end covers
- epoxy coating
- all stainless steel hardware
- potting compound
- closing tool

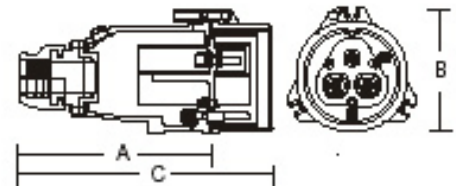
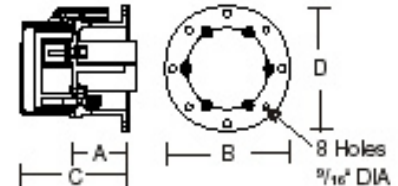

| item number                     | description              | dimension |        |        |        | kg (weight) |
|---------------------------------|--------------------------|-----------|--------|--------|--------|-------------|
|                                 |                          | A         | B      | C      | D      |             |
| <b>PK8S-M</b> <u>x</u> <u>y</u> | cable mounted male       | 356 mm    | 241 mm | 457 mm |        | 11,4        |
| <b>RK8S-F</b> <u>x</u> <u>y</u> | cable mounted female     | 445 mm    | 241 mm | 521 mm |        | 10,4        |
| <b>PK8F-M</b> <u>x</u>          | equipment mounted male   | 114 mm    | 267 mm | 229 mm | 235 mm | 7,7         |
| <b>RK8F-F</b> <u>x</u>          | equipment mounted female | 203 mm    | 267 mm | 272 mm | 235 mm | 7,3         |

| 250 AMP coupler catalog number suffixes - <u>x</u> & <u>y</u> |                       |                               |                       |
|---|-----------------------|-------------------------------|-----------------------|
| max. cable size x (mm <sup>2</sup> )                          | x- item number suffix | outside cable diameter y (mm) | y- item number suffix |
| 21  | 11                    | 20.8-47.5                     | A                     |
| 27  | 12                    | 47.8-60.2                     | B                     |
| 34  | 13                    |                               |                       |
| 42  | 14                    |                               |                       |
| 54  | 15                    |                               |                       |
| 67  | 16                    | 60.4-69.9                     | C                     |
| 85  | 17                    |                               |                       |
| 107   | 18                    |                               |                       |
| 127   | 19                    | 70.0-90.0                     | D                     |
| 178   | 21                    |                               |                       |